

# FUQUA BUSINESS CENTER – 17,600 SF FOR LEASE

City of Houston, Bay Area, Less than 1  
mile from I-45 and Beltway 8



DELIVERING 2Q16



- New  $\pm 35,200$  sq. ft. concrete tiltwall construction with  $\pm 17,600$  sq. ft. available -- divisible to  $\pm 8,800$  sq. ft. units
- Rear-load configuration
- 120' truck court
- 24' clear
- ESFR sprinklered
- Located in the NWQ of Hwy 3 and Beltway 8 South - one mile east of I-45, providing the site with excellent accessibility to the greater Houston MSA

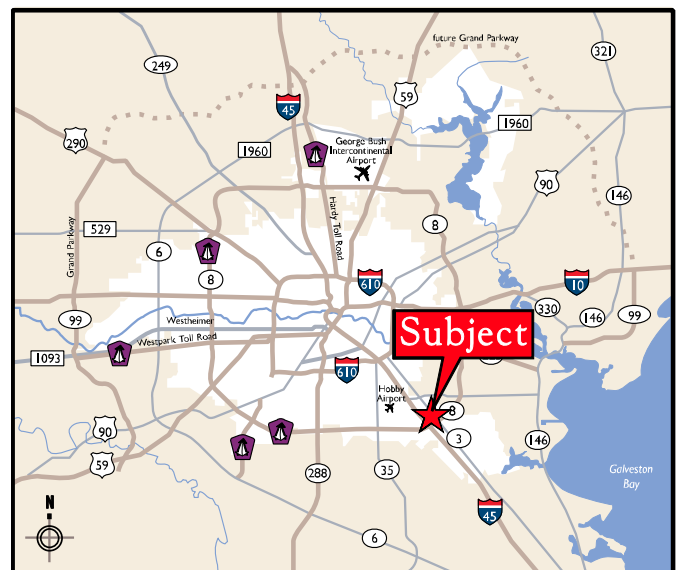

JAMES E. FOREMAN  
(713) 963 2824  
[jim.foreman@cushwake.com](mailto:jim.foreman@cushwake.com)

BEAU KALEEL, SIOR  
(713) 963 2844  
[beau.kaleel@cushwake.com](mailto:beau.kaleel@cushwake.com)

ALLISON HALL  
(713) 963-2865  
[allison.hall@cushwake.com](mailto:allison.hall@cushwake.com)

MICHAEL FOREMAN  
(713) 963-2850  
[michael.foreman@cushwake.com](mailto:michael.foreman@cushwake.com)

CUSHMAN & WAKEFIELD OF TEXAS, INC.  
1330 Post Oak Boulevard | Suite 2700  
Houston, TX 77056  
[www.cushmanwakefield.com](http://www.cushmanwakefield.com)

# FUQUA BUSINESS CENTER

Scheduled Completion: 2Q2016

## Proximity

Interstate 45	2 min; 1 mile
Beltway 8	1 min; 0.8 mile
SH 3	1 min; 0.2 miles
Clear Lake	15 min; 7.8 miles
League City	17 min; 10.3 miles
Galveston	44 min; 37 miles
Texas Medical Center	24 min; 17.4 miles

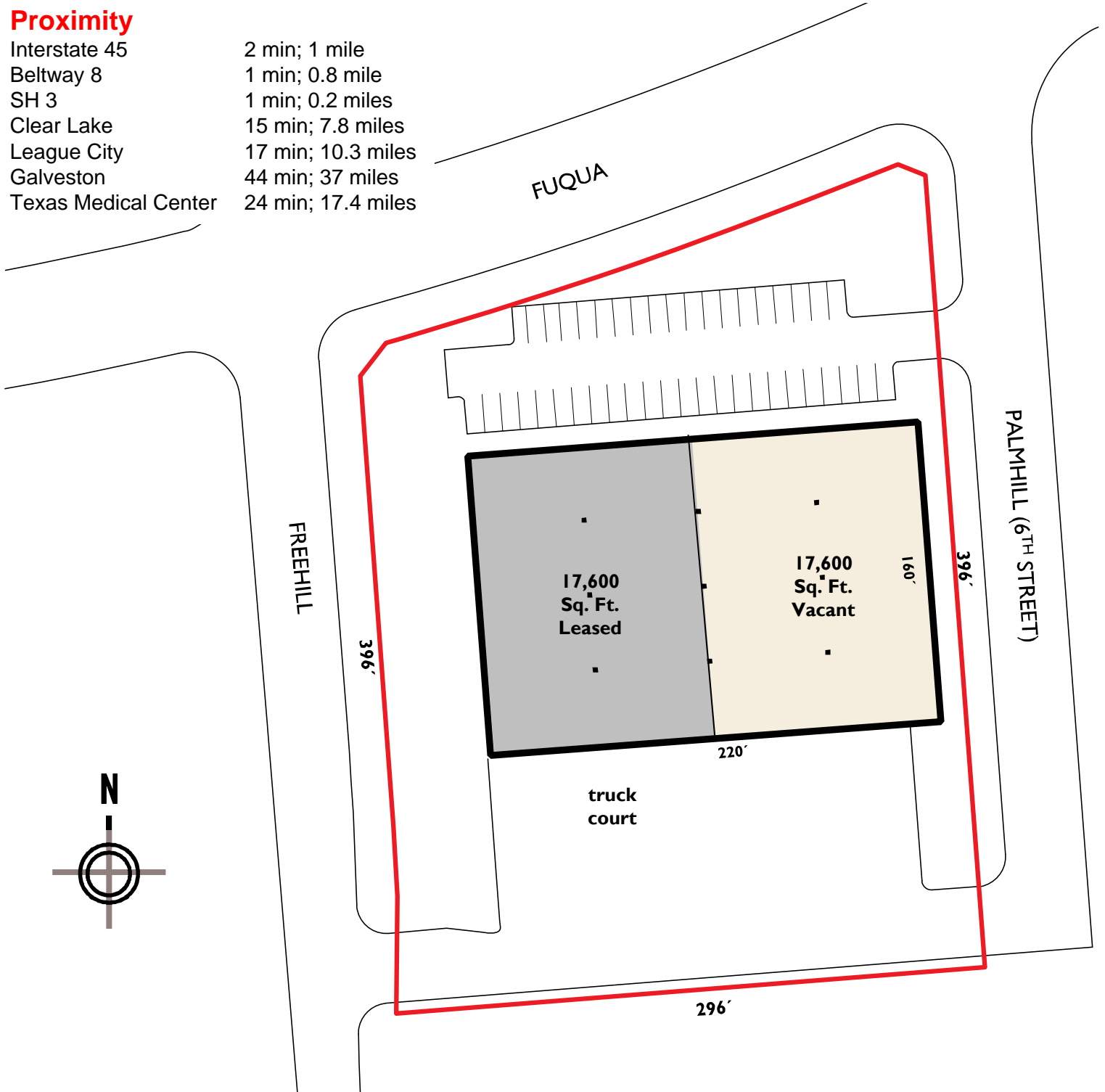

JAMES E. FOREMAN  
 (713) 963 2824  
[jim.foreman@cushwake.com](mailto:jim.foreman@cushwake.com)

BEAU KALEEL, SIOR  
 (713) 963 2844  
[beau.kaleel@cushwake.com](mailto:beau.kaleel@cushwake.com)

ALLISON HALL  
 (713) 963-2865  
[allison.hall@cushwake.com](mailto:allison.hall@cushwake.com)

MICHAEL FOREMAN  
 (713) 963-2850  
[michael.foreman@cushwake.com](mailto:michael.foreman@cushwake.com)

CUSHMAN & WAKEFIELD OF TEXAS, INC.  
 1330 Post Oak Boulevard | Suite 2700  
 Houston, TX 77056  
[www.cushmanwakefield.com](http://www.cushmanwakefield.com)